

150VDC General Purpose Fuse for EV/HEV KLMT4 Series

Description 描述

- ▶ General purpose fuse for EV/HEV用于纯电动汽车和混合动力汽车的全范围分断熔断器
- ▶ Stud-mount, optional for other installtion 螺栓安装提供其他安装方式选择
- ▶ 150Vdc ideal for EV or HEV application专为纯电动汽车和混合动力汽车设计的150V直流熔断器
- ▶ Excellent DC performance卓越的直流分断能力
- ▶ Special designed fuse base for vehicle situation提供专为汽车恶劣环境特殊定制的熔断器底座



Ordering PN Description/订购料号说明



Type & Assembly code/类型和安装方式代码:

- “M6” means Single and M6 bolt installation
- “M6”代表单体和M6螺栓安装
- “M8” means Single and M8 bolt installation
- “M8”代表单体和M8螺栓安装
- “VT” means vertical twins and M8 bolt installation
- “VT”代表垂直双拼和M8螺栓安装

Electrical Characteristics		
%of Ampere Rating (A)	Operating(s)	
	Min	Max
110%	14400	-
200%	1	300
300%	0.2	30
500%	0.1	10

Specifications 電氣特性

Type 類型	Ordering P/N 訂購料號	Rated Current 額定電流(A)	Rated Voltage 額定電壓(VDC)	Breaking Capacity 分斷能力(A)	1.0In Typical Voltage drop 額定壓降典型值(mv)	1.0In Power loss 額定功耗(W)
Single/ 单体	KLMT4-20-XX	20	150	10000	145	2.9
	KLMT4-25-XX	25			140	3.5
	KLMT4-32-XX	32			135	4.3
	KLMT4-40-XX	40			125	5.0
	KLMT4-50-XX	50			120	6.0
	KLMT4-60-XX	60			117	7.5
	KLMT4-80-XX	80			113	9.0
	KLMT4-100-XX	100			110	11.0
	KLMT4-125-XX	125			105	13.0
	KLMT4-150-XX	150			112	17.8
	KLMT4-160-XX	160			110	19.0
	KLMT4-180-XX	180			105	19.5
Twins/ 双拼	KLMT4-200-XX	200		100	20.0	
	KLMT4-250-XX	250		83	20.7	
	KLMT4-300-XX	300		77	23.1	
	KLMT4-400-YY	400		100	40.0	
	KLMT4-500-YY	500		90.5	45.2	
	KLMT4-600-YY	600		82	48.7	

- ▶ Percentage of change in fuse current carry capability Change in ambient temperature 熔断器随温度变化降额系数: -0.13%/°C
- *Temperature Rise 温升: <=75K with rated current 额定电流下小于等于75K(single only/僅用於單體)
- <=45K with 60% of rated current 60%额定电流小于45K

150VDC General Purpose Fuse for EV/HEV KLMT4 Series

Dimension (mm)尺寸

Single 单体

(安装端子厚度均为2mm)

Type & Assembly code:M6
类型和安装方式代码: M6

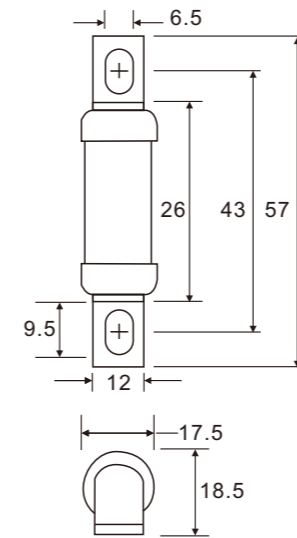

Type & Assembly code:M8
类型和安装方式代码: M8

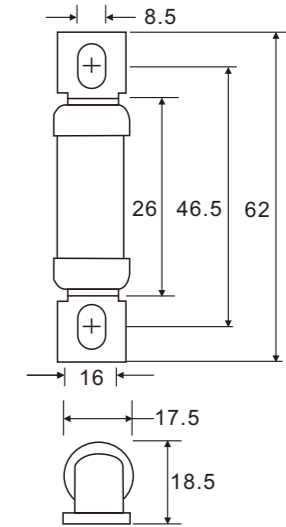

Twins 双拼

Type & Assembly code: VT
类型和安装方式代码: VT

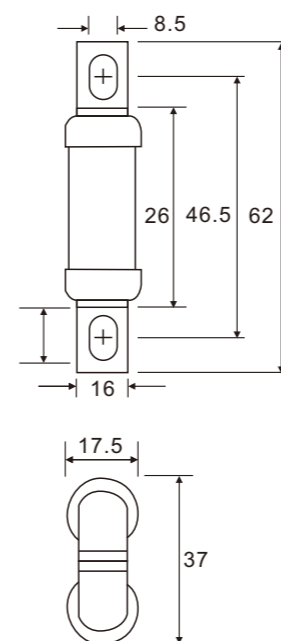

Time-Current Characteristics 时间-电流曲线

