

700VDC General Purpose Fuse for EV/HEV KEV1451 Series

Description 描述

- ▶ General purpose fuse for EV/HEV用于純電動汽車和混合動力汽車的全範圍分斷熔斷器
- ▶ Stud-mount, optional for other installtion 螺栓安裝, 提供其他安裝方式選擇
- ▶ 700Vdc ideal for EV or HEV application專為純電動汽車和混合動力汽車設計的700V直流熔斷器
- ▶ Excellent DC performance卓越的直流分斷能力
- ▶ Special designed fuse base for vehicle situation 提供專為汽車惡劣環境特殊定制的熔斷器底座



Electrical Characteristics		
%of Ampere Rating (A)	Operating(s)	
	Min	Max
110%	14400	-
200%	1	300
300%	0.2	30
500%	0.1	10

Specifications 電氣特性

Type 類型	Ordering P/N 訂購料號	Rated Current 額定電流(A)	Rated Voltage 額定電壓(VDC)	Breaking Capacity 分斷能力(A)	$I^2t(A^2S)$
Single 單體	KEV1451-5	5	700V	10000	37.5
	KEV1451-8	8			96
	KEV1451-10	10			150
	KEV1451-15	15			330
	KEV1451-20	20			400
	KEV1451-25	25			625
	KEV1451-32	32			1000
	KEV1451-40	40			1600
Twins 雙拼	KEV1451-50	50			2500
	KEV1451-60	60			4000
	KEV1451-80	80			8900
	KEV1451-100	100	12000		

- ▶ Percentage of change in fuse current carry capability Change in ambient temperature 熔斷器隨溫度變化降額系數: $-0.13\%/^{\circ}C$
 *Temperature Rise 溫升: $\leq 75K$ with rated current 額定電流下小於等於75K
 $\leq 45K$ with 60% of rated current 60%額定電流小於45K

700VDC General Purpose Fuse for EV/HEV KEV1451 Series

Dimension (mm)尺寸

Type: Single單體

Type: Twins雙拼

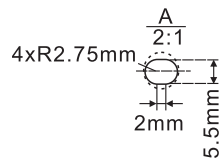
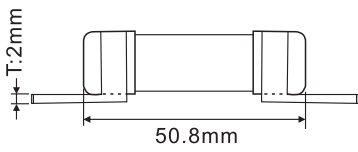
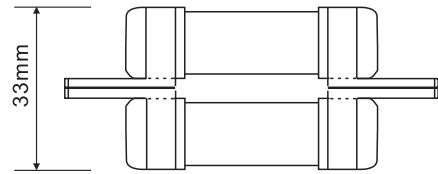
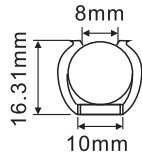
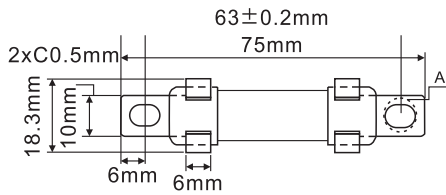

Time-Current Characteristics時間-電流曲綫

